

wing struts B 3x1,5



template for assembly, cut out only the sections of the wings, 3x

F. 60 Goliath

Farman

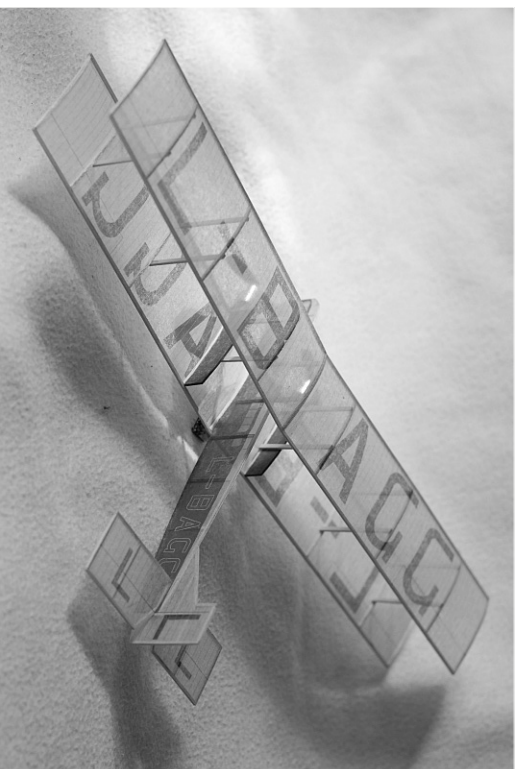

6x

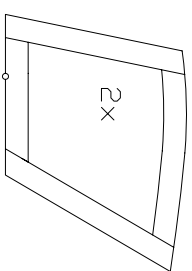

undercarriage leg B 3x1,5 carbon axis 1 mm; cover only the outer side

RX + Li-Pol

4x

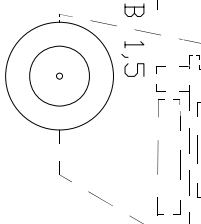

carbon axis, plastic tube

r/b 24x balsa 1,5x1,5

VARIANTS:

nacelle light balsa 1,5 mm 2x

- 1) RC - model is controlled only by the engine thrusts; 2x AC brushless Gasparin 10 UL, 3,7 V and Microinvent electronics, final weight 9 gms
- 2) or China toys, X-twin equipment, final weight 12 gms
- 3) Free flight - only 2x DC motor (4-5mm diameter) and battery Li-Pol 10-30 mAh, "charge-and-fly" without regulator, final weight 5-6 gms

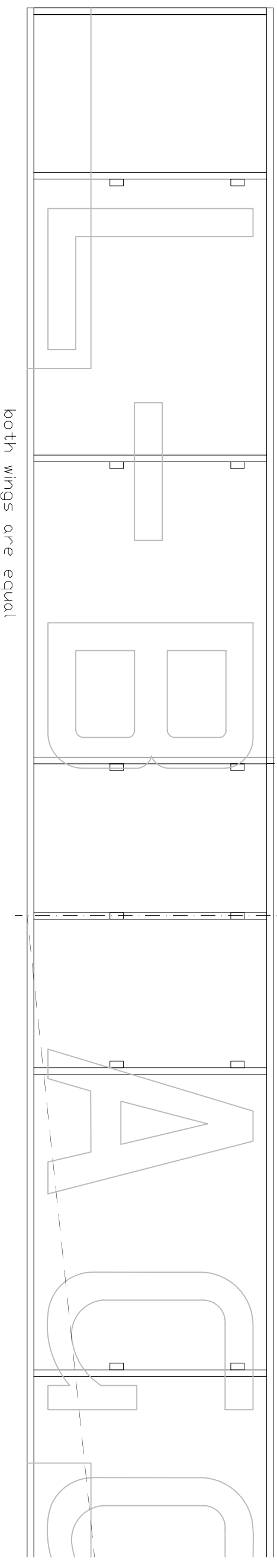

both wings are equal

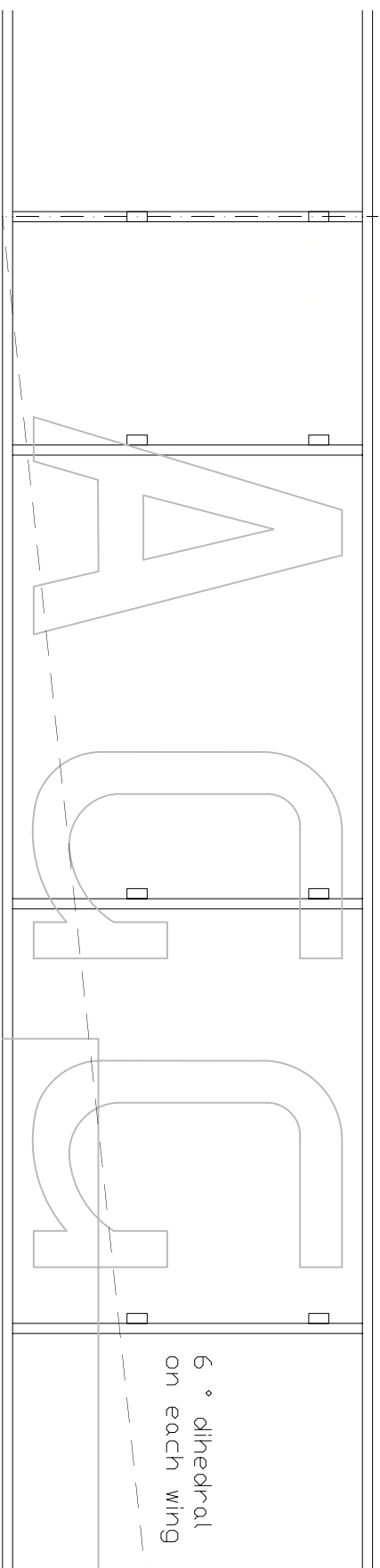

6 ° dihedral on each wing

REPUBLIQUE FRANÇAISE
 Farman FAO goliath
 wingspan: 406 mm; flight weight: 8-12 g;
 material: hard balsa 1,5 mm; covering tissue
 <12g/m<sup>2
 R. Pajás 2014
 M 1:1 80 mm
 15.00
 RFP</sup>